

LC: Can I calculate perimeter?

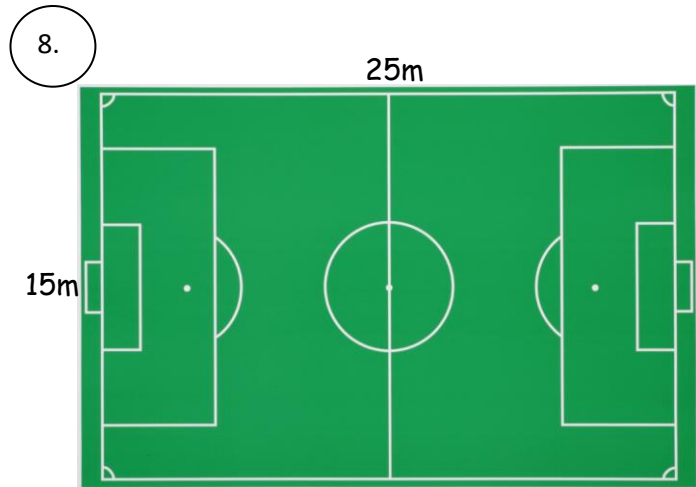
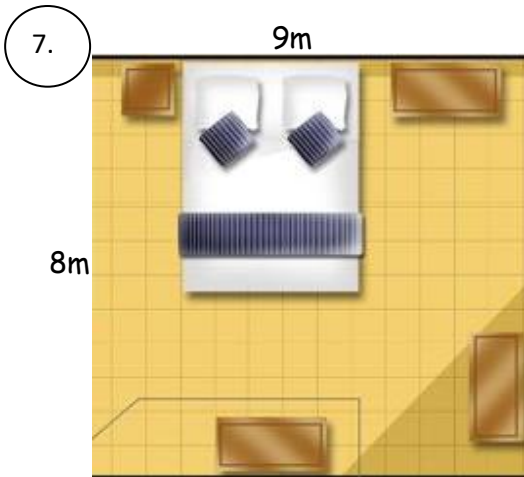
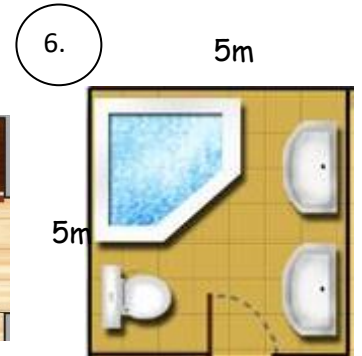
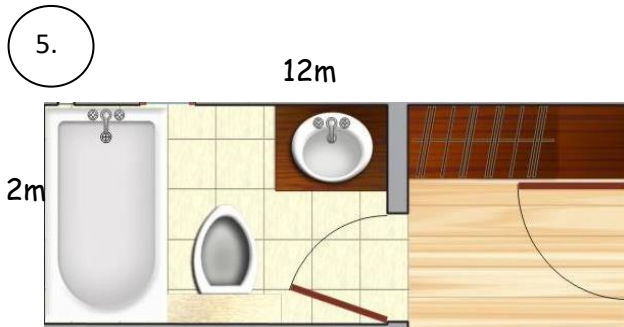
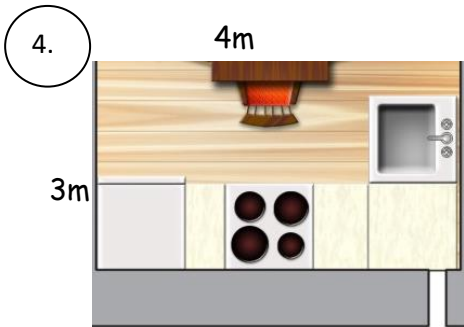
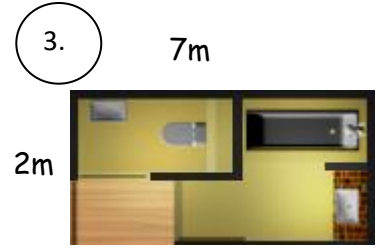
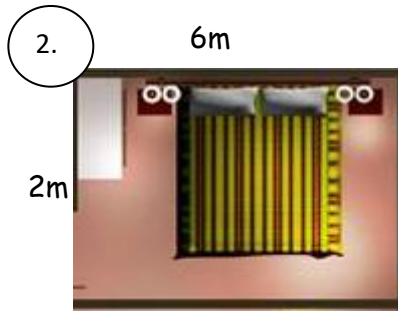
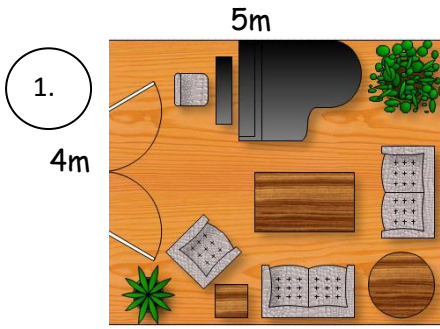

NOW: Measure 2 sides of these rectangles and then calculate the perimeter of them

9.

10.

11.

12.

13.

LC: Can I calculate perimeter?

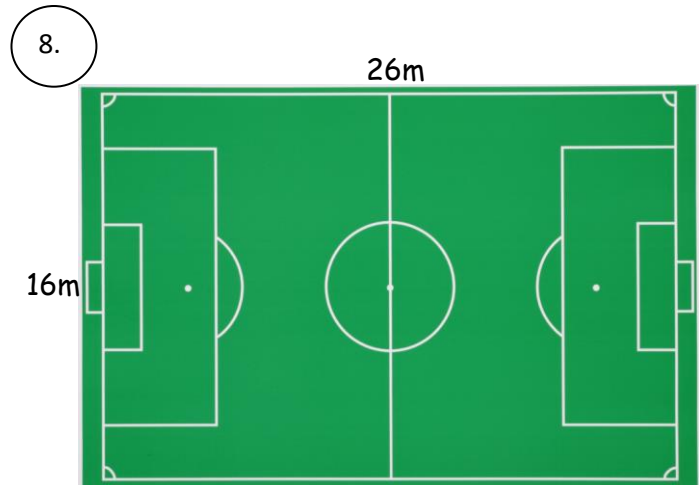
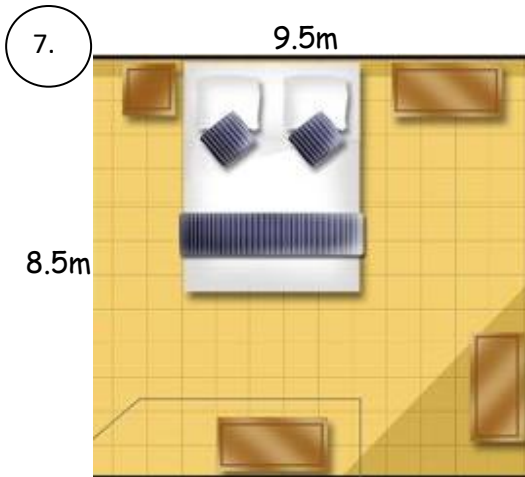
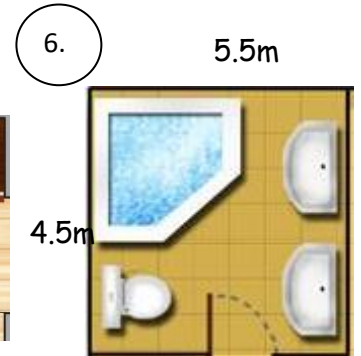
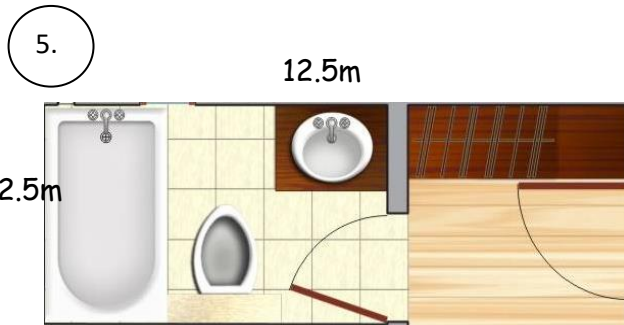
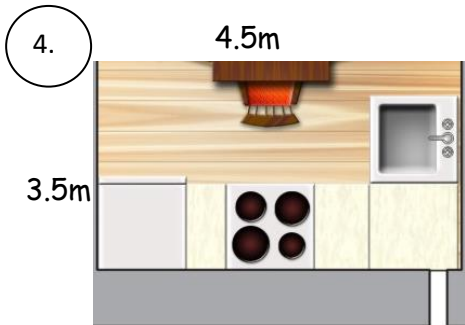
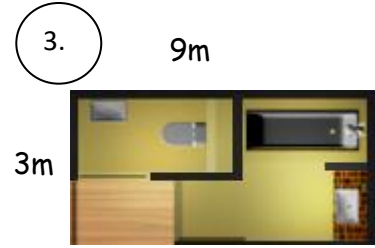
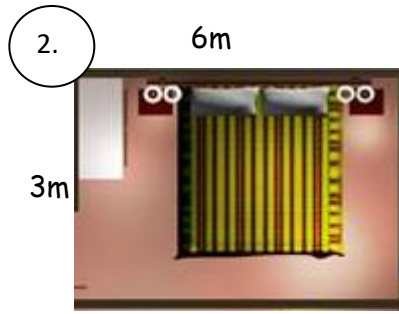
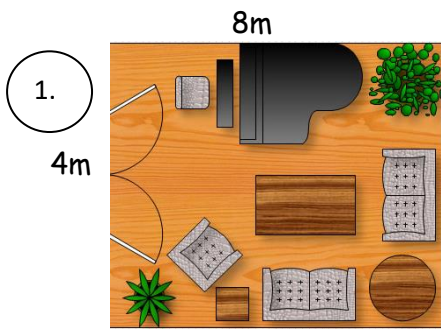

NOW: Measure 2 sides of these rectangles and then calculate the perimeter of them

9.

10.

11.

12.

13.

LC: Can I calculate perimeter?

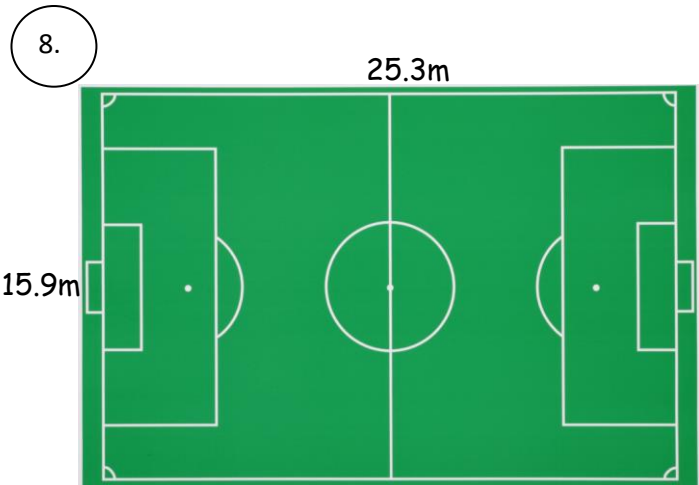
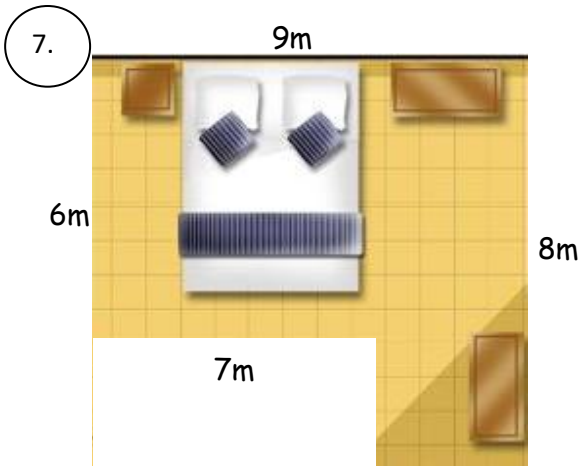
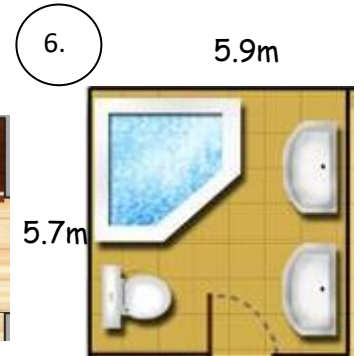
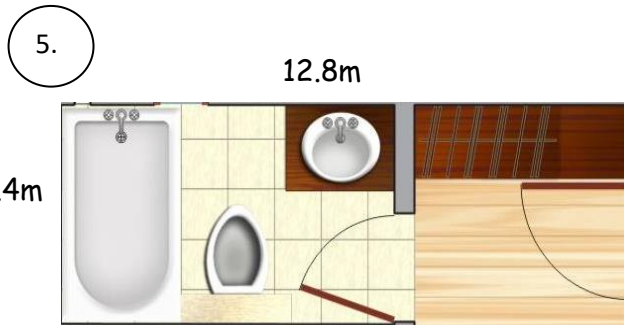
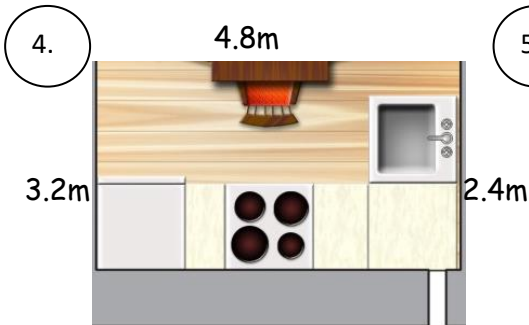
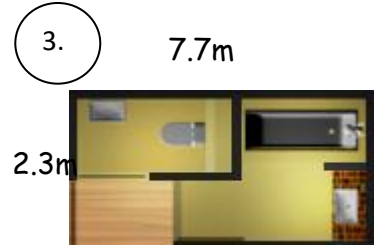
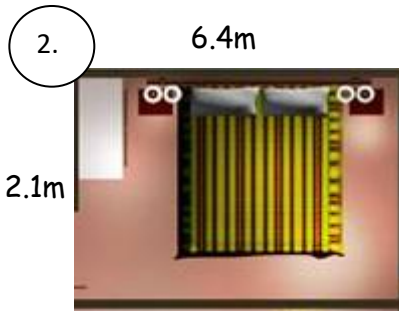
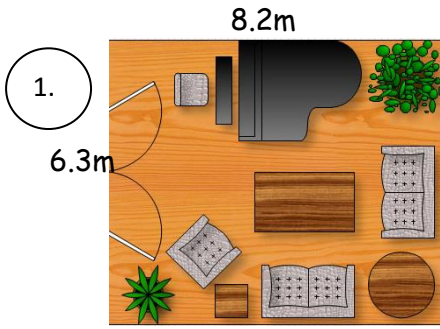

NOW: Measure 2 sides of these rectangles and then calculate the perimeter of them

9.

10

11

12

13